

A GUIDE TO MEZZANINES AND WORK PLATFORMS

Expanding *out* costs more than expanding *up*
cisco-eagle.com/mezzanines • 888-877-3861



 Cisco-Eagle

STRUCTURAL MEZZANINES

Pre-Engineered Work Platforms for Storage, Machinery, Offices, Processing Areas

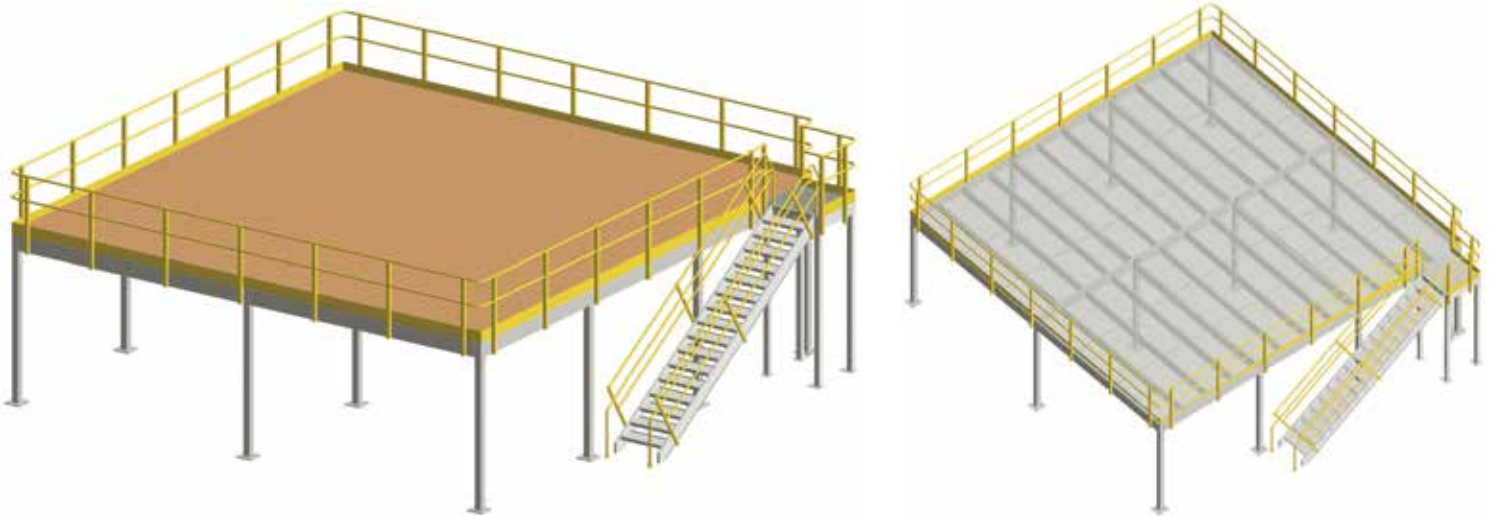

Added space at a moderate cost

Mezzanines are the most cost-effective way to add storage and work space to an industrial facility with high ceilings. Warehouses, distribution centers, aerospace facilities and manufacturing operations typically have space in the “air” that a structural mezzanine can take advantage of.

Structural mezzanines are pre-engineered

These work platforms are ideal because they shorten lead times and reduce costs when space is needed. Compared to the costs of traditional construction or new facilities, a mezzanine is the clear winner.

High strength, zinc plated steel bolts combine with heavy duty steel angles to align the framing for uniform installation. These integrated components lock the connection into a solid unit for maximum strength. They provide tremendous strength and load bearing capacity, with low composite heights available.

Structural systems meet the specifications for structural steel construction set by the American Institute of Steel Construction (AISC). In addition, all materials conform to the standards set by the American Society of Testing Materials (ASTM). All systems meet specified national, state and local

codes.

Structural vs. rack/shelf supported mezzanines

Structural mezzanines are more versatile in that they can be custom configured for a variety of storage and processing operations. Depending on the storage media involved, they can also offer more weight-bearing capacity. Shelving or rack supported systems are ideal for concentrated storage where you have many inventory positions, or a pick module is specified.

Structural systems shine where you need to support production equipment, integrate a conveyor system, want an in-plant office or lockers, have general storage needs, or manufacturing operations on the mezzanine. They can be built to virtually any shape or size (the listings on the next page are just a few standard sizes, and not indicative of the full range of structural solutions available).

[Click for help with your mezzanine](#)

PRE-ENGINEERED CONFIGURATIONS

Height (Feet)	Width (Feet)	Length (Feet)	Square Feet	Roof Decking Model Number	Wt. (Lbs.)	Bar Grating Model Number	Wt. (Lbs.)
8'	11'	15'-11 1/4"	176	WDNS11-16-8RD	3,995	WDNS11-16-8BG	4,521
		31'-5 1/2"	346	WDNS11-32-8RD	6,114	WDNS11-32-8BG	7,153
		46'-11 3/4"	517	WDNS11-47-8RD	8,288	WDNS11-47-8BG	9,838
		62'-6"	687	WDNS11-63-8RD	10,458	WDNS11-63-8BG	12,520
	21'-7"	15'-11 1/4"	346	WDNS22-16-8RD	5,906	WDNS22-16-8BG	6,938
		31'-5 1/2"	678	WDNS22-32-8RD	9,545	WDNS22-32-8BG	11,582
		46'-11 3/4"	1,015	WDNS22-47-8RD	12,914	WDNS22-47-8BG	15,956
		62'-6"	1,350	WDNS22-63-8RD	16,276	WDNS22-63-8BG	20,323
	32'-2"	15'-11 1/4"	515	WDNS33-16-8RD	7,814	WDNS33-16-8BG	9,352
		31'-5 1/2"	1,011	WDNS33-32-8RD	13,013	WDNS33-32-8BG	16,049
		46'-11 3/4"	1,512	WDNS33-47-8RD	17,909	WDNS33-47-8BG	22,442
		62'-6"	2,011	WDNS33-63-8RD	22,798	WDNS33-63-8BG	28,830
	42'-9"	15'-11 1/4"	684	WDNS43-16-8RD	9,756	WDNS43-16-8BG	11,800
		31'-5 1/2"	1,343	WDNS43-32-8RD	16,480	WDNS43-32-8BG	20,514
		46'-11 3/4"	2,010	WDNS43-47-8RD	22,908	WDNS43-47-8BG	28,933
		62'-6"	2,672	WDNS43-63-8RD	29,320	WDNS43-63-8BG	37,336
9'	11'	15'-11 1/4"	176	WDNS11-16-9RD	4,094	WDNS11-16-9BG	4,620
		31'-5 1/2"	346	WDNS11-32-9RD	6,237	WDNS11-32-9BG	7,276
		46'-11 3/4"	517	WDNS11-47-9RD	8,435	WDNS11-47-9BG	9,985
		62'-6"	687	WDNS11-63-9RD	10,629	WDNS11-63-9BG	12,691
	21'-7"	15'-11 1/4"	346	WDNS22-16-9RD	6,029	WDNS22-16-9BG	7,061
		31'-5 1/2"	678	WDNS22-32-9RD	9,704	WDNS22-32-9BG	11,741
		46'-11 3/4"	1,015	WDNS22-47-9RD	13,109	WDNS22-47-9BG	16,151
		62'-6"	1,350	WDNS22-63-9RD	16,507	WDNS22-63-9BG	20,554
	32'-2"	15'-11 1/4"	515	WDNS33-16-9RD	7,961	WDNS33-16-9BG	9,499
		31'-5 1/2"	1,011	WDNS33-32-9RD	13,208	WDNS33-32-9BG	16,244
		46'-11 3/4"	1,512	WDNS33-47-9RD	18,152	WDNS33-47-9BG	22,685
		62'-6"	2,011	WDNS33-63-9RD	23,089	WDNS33-63-9BG	29,121
	42'-9"	15'-11 1/4"	684	WDNS43-16-9RD	9,927	WDNS43-16-9BG	11,971
		31'-5 1/2"	1,343	WDNS43-32-9RD	16,711	WDNS43-32-9BG	20,745
		46'-11 3/4"	2,010	WDNS43-47-9RD	23,199	WDNS43-47-9BG	29,224
		62'-6"	2,672	WDNS43-63-9RD	29,671	WDNS43-63-9BG	37,687
10'	11'	15'-11 1/4"	176	WDNS11-16-10RD	4,762	WDNS11-16-10BG	4,894
		31'-5 1/2"	346	WDNS11-32-10RD	7,268	WDNS11-32-10BG	7,636
		46'-11 3/4"	517	WDNS11-47-10RD	9,825	WDNS11-47-10BG	10,431
		62'-6"	687	WDNS11-63-10RD	12,379	WDNS11-63-10BG	13,223
	21'-7"	15'-11 1/4"	346	WDNS22-16-10RD	7,048	WDNS22-16-10BG	7,421
		31'-5 1/2"	678	WDNS22-32-10RD	11,329	WDNS22-32-10BG	12,230
		46'-11 3/4"	1,015	WDNS22-47-10RD	15,336	WDNS22-47-10BG	16,769
		62'-6"	1,350	WDNS22-63-10RD	19,336	WDNS22-63-10BG	21,301
	32'-2"	15'-11 1/4"	515	WDNS33-16-10RD	9,332	WDNS33-16-10BG	9,945
		31'-5 1/2"	1,011	WDNS33-32-10RD	15,423	WDNS33-32-10BG	16,862
		46'-11 3/4"	1,512	WDNS33-47-10RD	21,210	WDNS33-47-10BG	23,475
		62'-6"	2,011	WDNS33-63-10RD	26,989	WDNS33-63-10BG	30,083
	42'-9"	15'-11 1/4"	684	WDNS43-16-10RD	11,648	WDNS43-16-10BG	12,503
		31'-5 1/2"	1,343	WDNS43-32-10RD	19,515	WDNS43-32-10BG	21,492
		46'-11 3/4"	2,010	WDNS43-47-10RD	27,086	WDNS43-47-10BG	30,186
		62'-6"	2,672	WDNS43-63-10RD	33,533	WDNS43-63-10BG	38,864

Only a small sample of what's possible — many sizes and configurations available

- You can specify shape, decking, colors, and many other factors. This is only a small sample of what is possible.
- Listed modular platform mezzanines include decking, handrail, stairway, and landing.
- The mezzanines listed are Beam & Beam style construction.
- Standard mezzanines are not designed for point-loading. Contact us for assistance with heavy, point-load applications.
- Steps: 36" wide, 11" deep with 7" rise.
- Stairway landing is 42" x 42" and features a diamond-plate deck. Other sizes are available.
- Guardrail is 2.5" x 2.5" square tubing uprights with 1.5" diameter horizontal tubing. Depending on building code regulations, mezzanines can have two or three rails.
- Height dimensions refer to clearance below the structure. Heights at the top of platform are typically 1'2" taller.
- Mezzanine platform, stairs and landing are finished in gray. Railing is finished in safety yellow. Other colors are available—contact us for assistance.
- All structural mezzanines require approval drawings.

Code & Seismic Zone Compliance

Meet the specifications for structural steel construction set by the American Institute of Steel Construction (AISC), IBC (International Building Code), and OSHA requirements. If your mezzanine requires UBC (Uniform Building Code) compliance, contact us. All construction materials conform to American Society of Testing Materials (ASTM) standards. Building permits may be required (consult your local building authorities).

Most mezzanine applications are specified non-seismic, outside of California. If you know you are in a seismic zone area that requires a seismic mezzanine, see below.

[Detailed modular mezzanine prices, specs and more](#)